

PRODUCT SPECIFICATION

small waste bin ONE pure PU-230

specification text

small waste bin ONE pure,
made out of stainless steel.

dimensions: 300 x 320 x 150 mm

Small waste bin 300x320x150 mm made out of stainless steel. Surface with fine brushed structure. Cover 1.5 mm thickness. Intended for wall mounting. Perforated design area with 4mm drillings. Integrated bag holder. 14 litres capacity. Includes stainless steel screws and plugs.

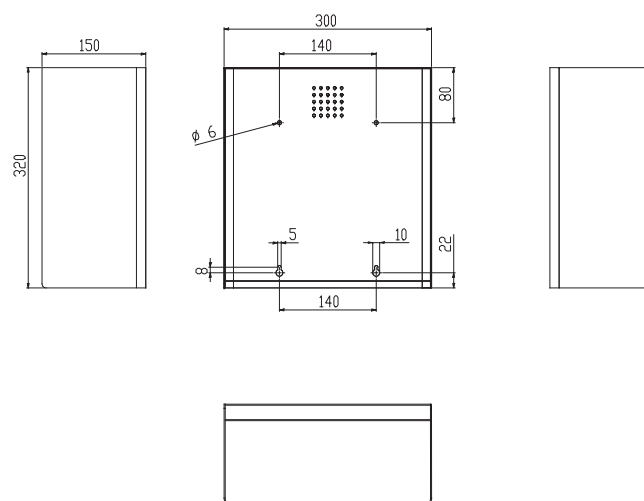

further product recommendations



paper towel dispenser
PU-100



soap dispenser
PU-140



tissue dispenser
PU-190



double toilet roll holder
PU-300



toilet brush holder
PU-500